

# FTW NEWSLETTER

27th February 2022

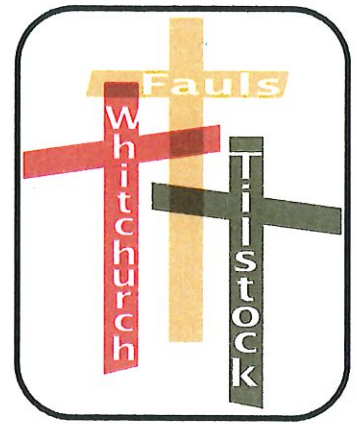

# LENT



## Pastoral Letter

Dear Friends,

'Help us to use these days to grow in wisdom and prayer' *from the Collect for 1st Sunday in Lent.*

As we move into Lent we so often think of the potential to direct our thoughts into a more reflective mode. Jesus, during his time in the wilderness began to prepare himself for what lay ahead. This is what we too can do by taking time to read, pray and discuss our faith, our lives, our future. Lent courses, Lent services give us the time and space for this, encouraging us to open hearts and minds to other ways of thinking and of responding. Perhaps being led to reach out in other ways, developing fresh ways of relating to our world and those who are in it.

Traditionally a time of 'giving up,' Lent offers instead the opportunity to 'Take up'. Christian charity does not have to be only the giving of our wealth – it could instead be giving of ourselves. Giving some time: a regular visit to a lonely friend, ½ a day a week to support a charity, offering transport to a housebound neighbour or a regular phone call. All of these are actively showing a desire to share God's love with those around us – of course they require a bit more from us than donating money does, but what we show [and what we gain] when God's love is demonstrated in this way is real, not just lip-service.

Yours in Christ, Revd Sue

## Dates for your diary

Weds 2nd March	7.30pm	Ash Weds service in St Alkmund's, W/ch
Fri 4th March	2.00pm	World Day of Prayer Service in St John's , W/ch Followed by refreshments
Sat 12th March	12noon to 2.00pm	Saturday Soup in Tilstock Village Hall
Sat 19th March	All day in W/ch	Caldecott Festival
Sun 3rd April	10.00am	Confirmation Service in St Alk's, W/ch
Thurs 14th April	7.30pm	Maundy Thursday Service in St John's Methodist Church in W/ch
Fri 15th April	10.00am 11.30am	Good Friday Meditative Service in St Alk's, W/ch Good Friday Walk of Witness from Tesco's. W/ch
Sat 7th May	Morning Evening	Plant Sale in Bargates, W/ch ? Concert in St Alk's, W/ch
Sun 22nd May	?6.30pm	Rogation Service w Tullis Matson
Sun 29th May	10.30am	Joint FTW Service - ? at Fauls
Sunday 5th June	???	Special services for the Queen's Jubilee
Fri 24th Jun	Morning	Christ Church, Tilstock's Coffee Morning in the Civic Centre
Sun 31st July	10.30am	FTW Joint Service - ? at Tilstock
Fri 12th Aug	Morning	St Alk's Coffee Morning in the Civic Centre
Sat 12th Nov	Morning	St Alk's Christmas Coffee Morning – Civic Centre

# LENT & HOLY WEEK

## Lent Lunches

## Services in Holy Week & Easter

**All Welcome!**

### Fauls Lent Lunches

These will be on Tuesdays in the Church Hall. They begin with a short service at 12.30pm, a light lunch follows. Dates: 8th, 15th, 22nd & 29th March and 5th April.

Donations welcome - which will be passed on to a charity chosen by the church.

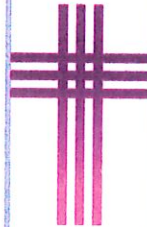

### Holy Week

Mon 11th 7.00pm Meditation on Zoom

Tues 12th 7.00pm Meditation on Zoom

Weds 13th 7.00pm Meditation on Zoom

*For all of the above, please contact Revd Judy to get the necessary link*

Thurs 14th April **MAUNDY THURSDAY**  
7.30pm Maundy Thursday Service for FTW & Churches Together in St John's Methodist Church W/ch

Fri 15th April **GOOD FRIDAY**  
10.00am Meditative Service in St Alkmund's, W/ch  
11.30am Churches Together Procession of Witness from Tesco's Car Park

### Easter

**Sun 17th April —EASTER DAY**

8.00am BCP Communion in St Alkmund's, W/ch

8.30am St Alkmund's Easter Breakfast in Bargates Hall, W/ch

9.30am All Age Communion in Holy Immanuel, Fauls

10.00am All Age Communion in St Alkmund's, W/ch

11.00am All Age Communion in Christ Church, Tilstock

6.30pm Easter Evensong in St Alkmund's, W/ch

### Churches Together in Whitchurch Lent Discussion group and Christian Aid Lunches

During Lent people from the churches in Whitchurch meet each week to eat together on a Thursday lunch time between 12.30 and 2.00pm. It is a simple meal of bread, soup, and fruit and a hot drink (no cheese this year!). It creates a space in our busy lives when we can spend time together and get to know each other a bit better. The atmosphere is always very welcoming, happy and relaxed. The money we would have spent on lunch is given to Christian Aid. £4.00 or £5.00 donation suggested. Please do come along if you have not been before and if you have, please come again!

Date	Church hosting	Venue
10th March	St John's	St John's
17th March	St George's	Bargates Hall
24th March	Beacon	St John's
31st March	St Alkmund's	Bargates Hall
7th April	Christian Aid group	St John's

This year, a **discussion group** will meet at 11.00am on the same days. The theme is likely to be "Following Christ in the Footsteps of the Saints." Location for each week – as above for the lunches.

## St Alkmund's Building:

The PCC of St Alkmund's has agreed to apply for permission for various works, you can see the architect's plans for these on the pages at the back of this newsletter. The basics are:

1. Removable Handrails to be installed at either side of the Chancel Steps. This will help people with some balance / mobility issues to access the Chancel more easily.
2. Installation of a disabled access toilet in the vestry. This is the only location in the church for which we are likely to gain permission. It will continue our progress to making the building welcoming to all people.
3. Re-ordering the north porch area: upgrading the toilet and creating better facilities for the flower arrangers. There will also be space to store chairs on trolleys which can be put out for services which have maximum numbers to replace the removed pews (see below)
4. Installing a kitchen area in the northwest corner. This will mean that we have better facilities for refreshments and in line with health and safety regulations which state that we should not have toilet facilities leading off from a kitchen area
5. Removing two pews from the front (east) of the nave. This will mean that those with physical disabilities and others can move around more easily. It will also create a more flexible space for concerts and services, together with enabling the piano to be moved to the centre of the church.
6. Removing two pews from the back (west) of the nave. This will create a better space for serving and consuming refreshments as well as space for displays. Storage facilities will also be increased.
7. Removing pews from the Lady Chapel and replacing with good quality chairs. This will create a more flexible and inviting space for small services and for the signing of marriage documents.

There will be a need to re-locate the sound system desk. We plan to use this opportunity to upgrade the system and incorporate facilities for recording and live-streaming our services and other events.



Prayer Update is sent out by [geoff.barter@gmail.com](mailto:geoff.barter@gmail.com) or Geoff Barter, 1 Rowlatt Court, Hillside Road, St. Albans AL1 3QU England. Please send me any address changes. Check for the latest news on Crosslinks mission partners and associates on our web site <http://www.crosslinks.org>

# Alison Talbert

## Prayer Update February/March 2022

Dear friends,

Apologies for this very late email- I've been resting with my feet up. No- not just being lazy but recuperating after a minor op to move some lumps on my toes that were causing problems. From seeing the surgeon in outpatients (no appointment required) to surgery took only 1 week.

Before that I was stressing about the application for renewal of my work permit and the day it expired, I had to visit the local immigration office in Malindi to get a 2 month stamp in my passport. I'm happy that the work permit has now been issued so I'm legally a resident (and allowed to work) for the next 2 years.

Looking at my prayer requests from last month, some have still not been answered such as our bible study group meeting again, and the writing up of the Upendo strategic plan, but we have had more meetings with the Gates Foundation and have engaged some more collaborators to help with planning and advising the multiple micronutrients supplement study. We hope to build lab capacity in Kilifi to measure vitamin and mineral levels, and plan to take on masters and PhD students.

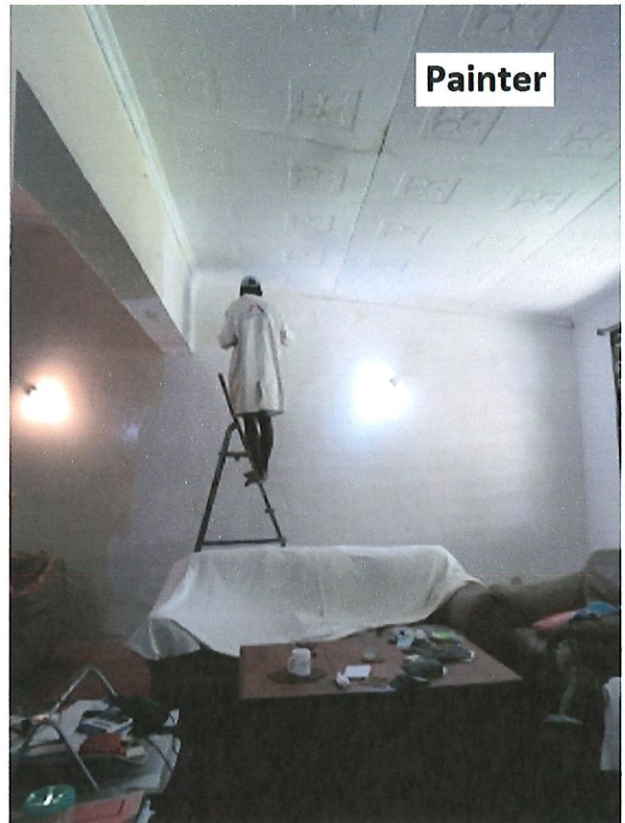

I've had some rooms in my house painted as I am expecting a visitor next month- the first in over 2 years. She's a lovely lady called Joy, who is a trustee of one of the charities helping Upendo. Her organization supports the feeding programme for the 60 Upendo children, who receive 3 meals a day, 6 days a week at the project.

I thank God that:

- the Omicron wave has passed in Kenya and test positivity rates are less than 1%
- my work permit has been issued without the need to pay for a special pass
- I was able to get treatment for my feet easily

Please pray for:

- orphans who have low self-esteem

- budget and study design discussions with the Gates Foundation
- Joy's visit to Upendo on March 7-11<sup>th</sup> and good health during her travels in Kenya
- speedy healing of my feet so I can finish fieldwork visiting mothers

With love in Christ,  
Alison

Back of  
Church  
South

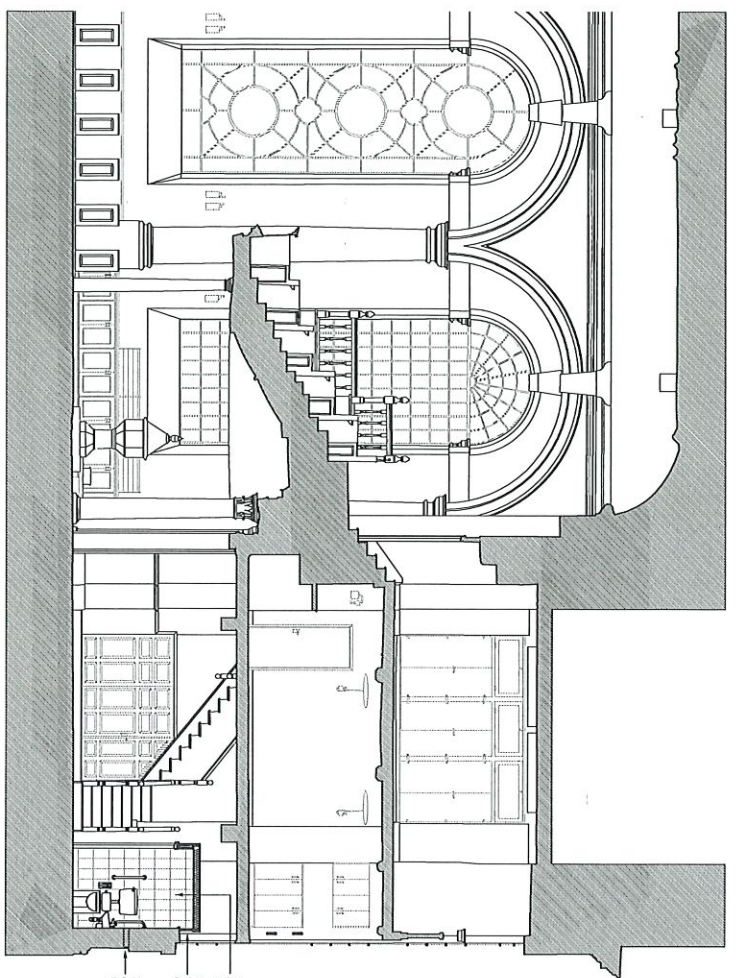

Section AA - along central aisle looking south

New accessible ramp, formed in the lower room within the window recess.  
 Narrow secondary window enclosing the space and providing some natural daylight.  
 Extract fan with cast iron air grille centrally beneath projecting canopy.

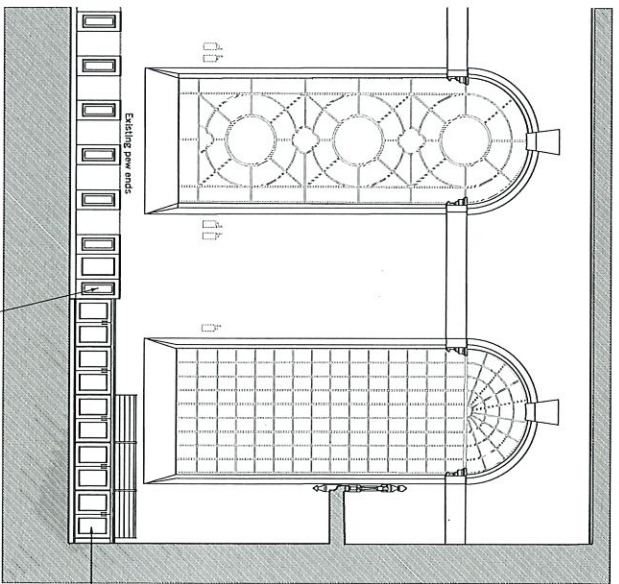

Section BB - along south aisle looking south

New glass-topped display for historic cupboards set level with the general floor, enclosed with new infill panel as part of the new construction.

New oak storage cupboards with book/radiator display need above.

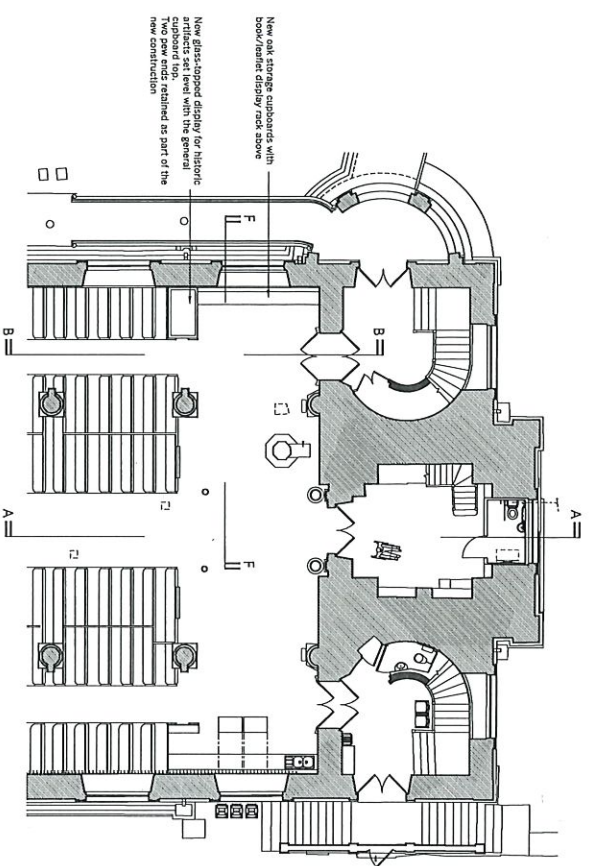

Part plan for reference (1:100)

New glass-topped display for historic artifacts set level with the general floor.  
 Two new ends retained as part of the new construction.

New oak storage cupboards with book/radiator display need above.

New oak storage cupboards with book/radiator display need above brass air grille behind over existing pipes.

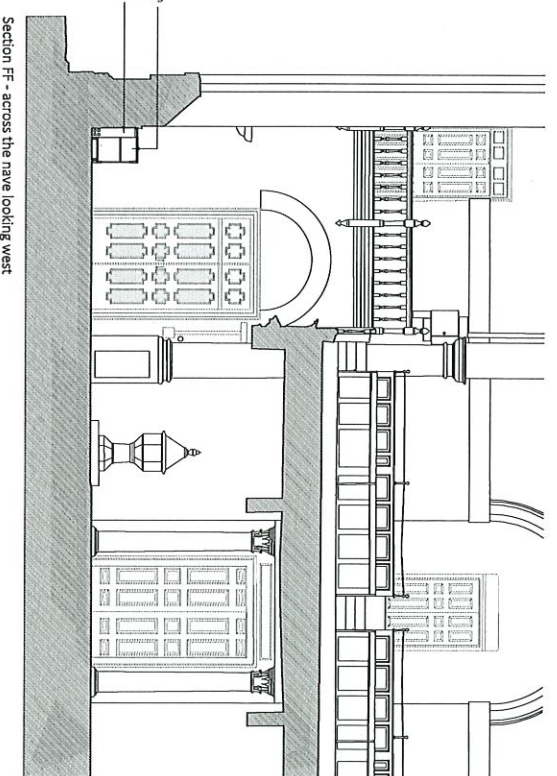

Section FF - across the nave looking west

Rev. Dr. Martin D. Smith  
 41 Dorset St  
 London W1K 6AF  
 T: 011 232 2033  
 W: www.bentley.com

**Buttress**

Project Title: St Andrew Church  
 Client: Mr DC & B Architects, Warwick  
 Location: Warwick, Warwickshire  
 Drawing Title: Internal structural elevations  
 Proposed (indicated to client)

Date:	April 2019	Scale:	1:50
Drawn by:	CH	Checked by:	AW
Job No:	8889	Drawing No:	(06) 01

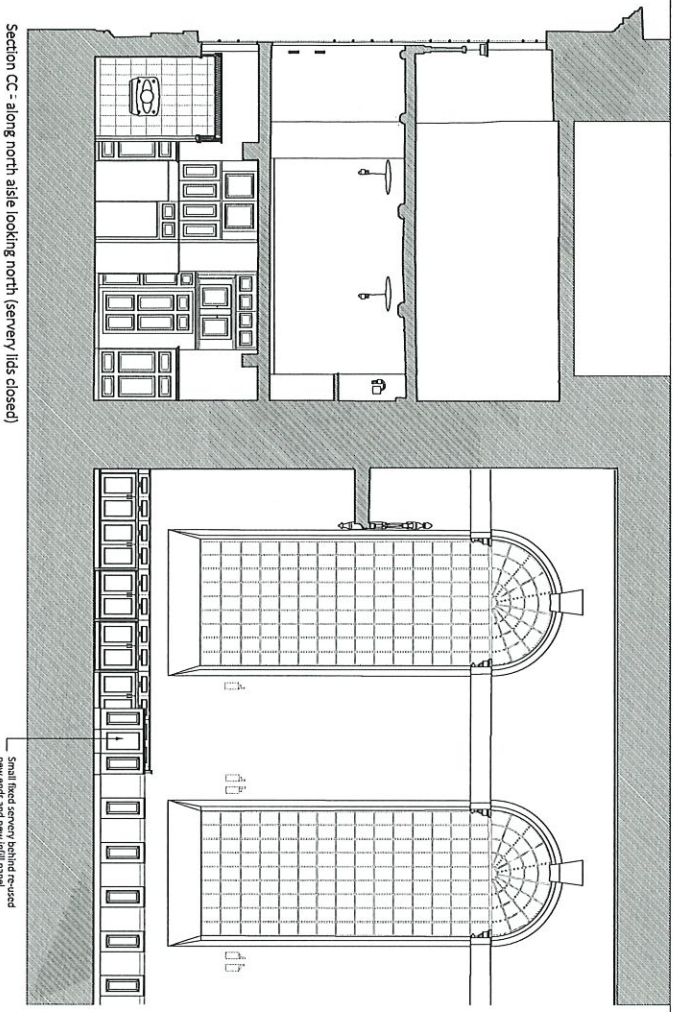

Section CC - along north aisle looking north (servery lids closed)

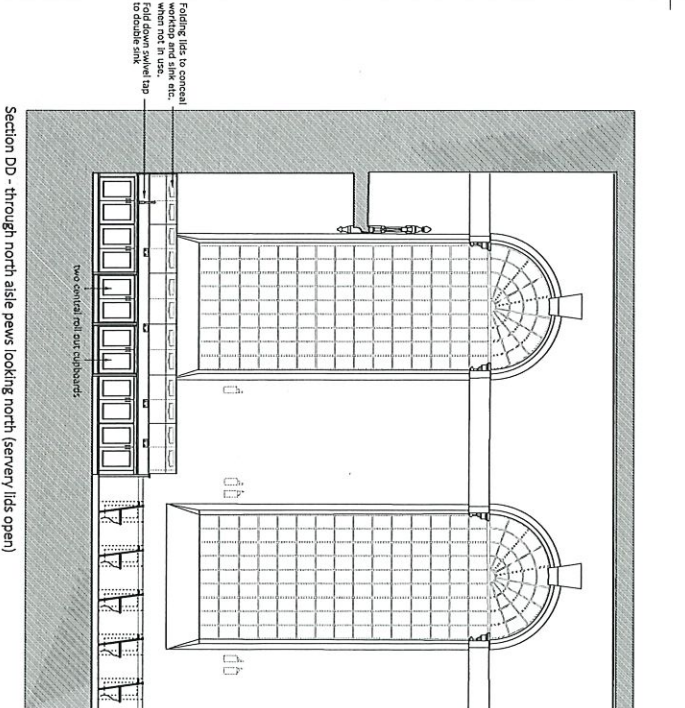

Section DD - through north aisle pews looking north (servery lids open)

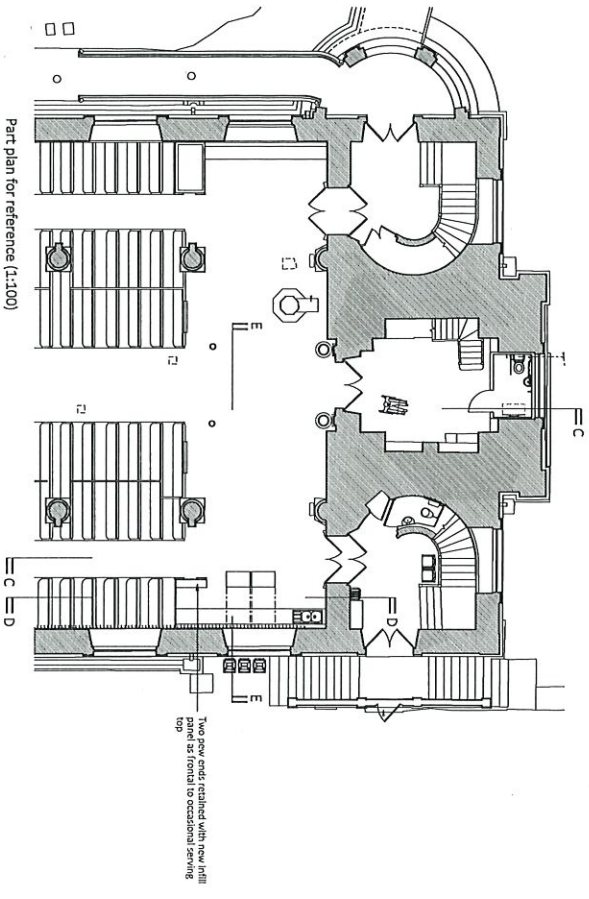

Part plan for reference (1:100)

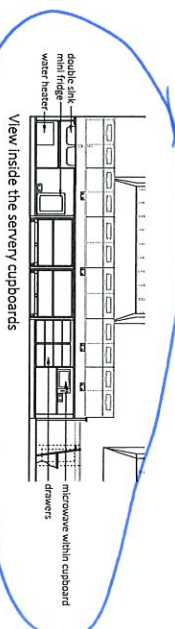

View inside the servery cupboards

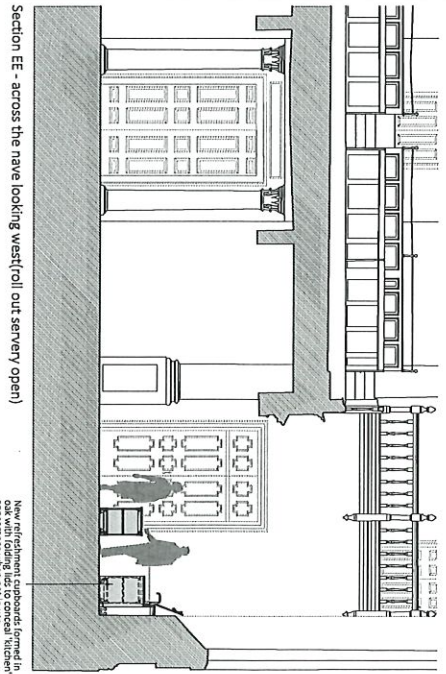

Section EE - across the nave looking west (roll out servery open)

*May change slightly*

Back  
of Church  
North

Note:  
Do not scale from this drawing  
If in doubt, please ask.

**Buttress**

**AW Drawing: Details**  
The title and content of this drawing shall be read in conjunction with the following information:  
Drawing No: 8889  
Rev: 02  
Date: 13/02/2021  
Scale: 1:50  
Project: St Andrew's Church, Wokingham, Hampshire  
Client: Wokingham Synagogue  
Drawing Title: Internal servery alterations  
Proposed alterations area to north aisle

Project Title	St Andrew's Church
Client	AW-PC (St Andrew's, Wokingham)
Architect	Wokingham Synagogue
Drawing Title	Internal servery alterations
Proposed alterations area to north aisle	
Date	December 2021
Checked by	Scale 1:50
Scale	Orig Paper 294 A1
Drawing of Job No	8889
Drawn by	0261 02
Revision	

Chancel  
Step  
Handrails

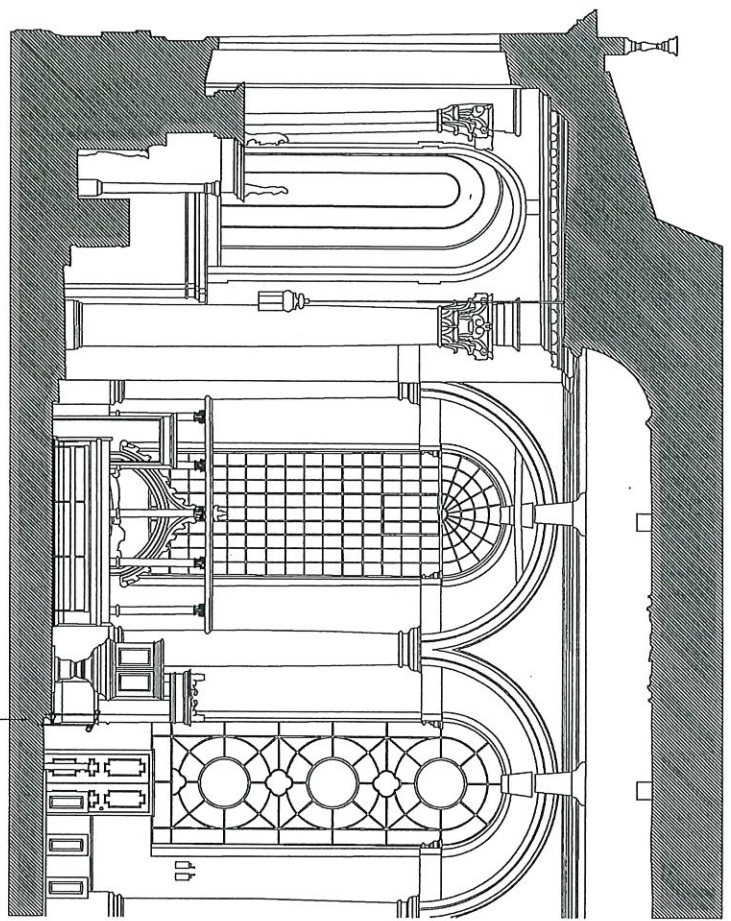

Section across chancel scale 1:50

Proposed new handrails to chancel steps, one to each side, set in alignment with the peak of the steps and 500mm away from the face of the wall with balusters continuing down 150mm into stainless steel cylinder floor sockets as 16mm diameter rods, allowing for removal when handrails are not in use. Handrails to be painted black.

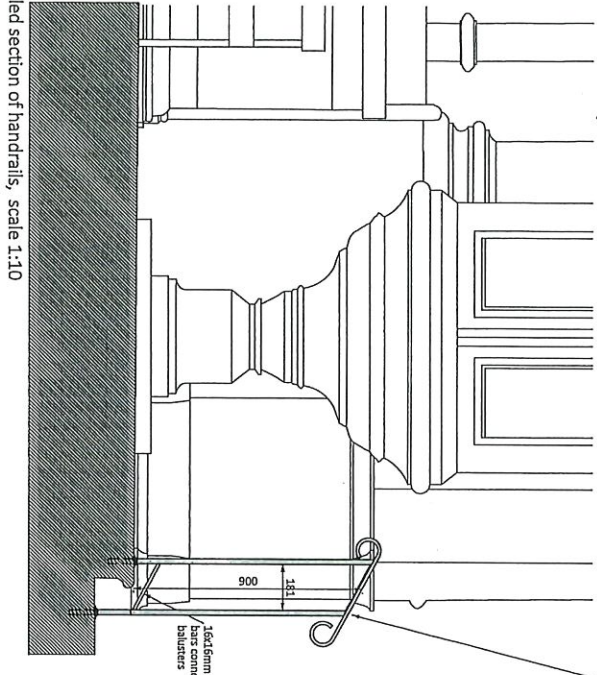

Detailed section of handrails, scale 1:10

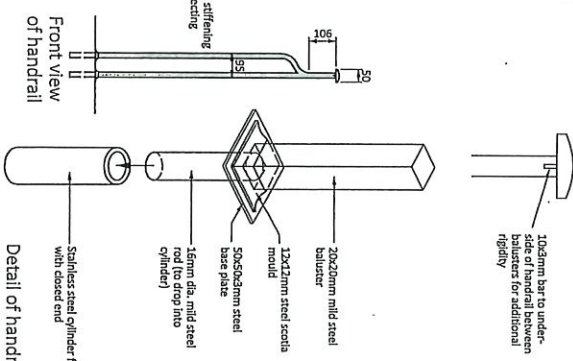

Front view of handrail  
Detail of handrail base, scale 1:2

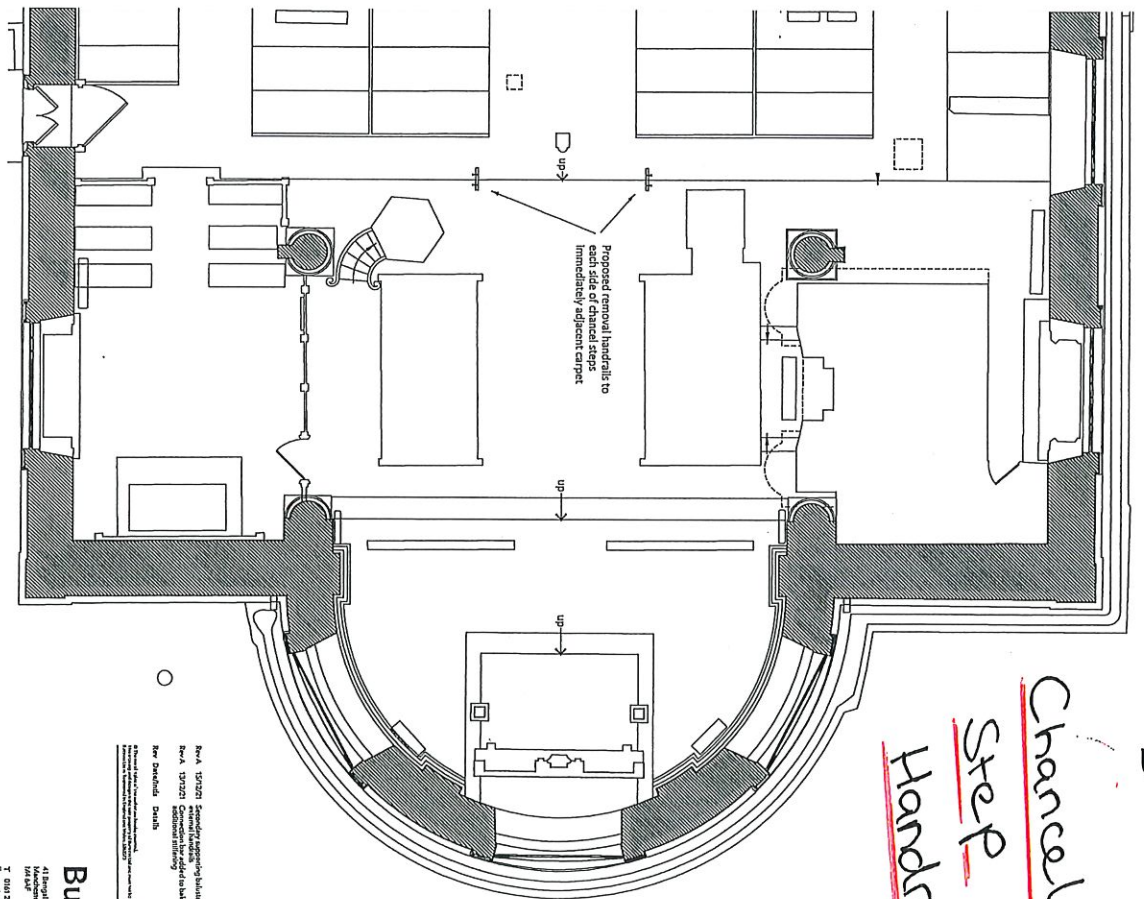

Plan at east end of church scale 1:50

**Buttress**

1:10  
1/4" = 1'-0"  
1/2" = 1'-0"  
3/4" = 1'-0"  
1" = 1'-0"

Rev A 13/12/21 Resolving existing building added building  
Rev A 13/12/21 Conditions to be added to schedule to provide  
Rev 08/08/20 Drawn

Project Title	St Andrew Church	Scale	1:10 & 1:50
Client	Rev Rector of St Andrew, Wincoburn	Drawn by	AI
Location	Wincoburn, Hampshire	Checked by	AI
Drawing Title	Proposed handrails to chancel steps	Drawn by	AI
Date	Nov 2021	Scale	1:10 & 1:50
Checked by	AI	Orig Paper Size	A1
Drawn by	AI	Drawn by	AI
Job No	8889	Drawing No	B





Note:  
Do not scale from this drawing.  
Dimensions are to be checked on site.  
If in doubt please ask.

# Overall Project

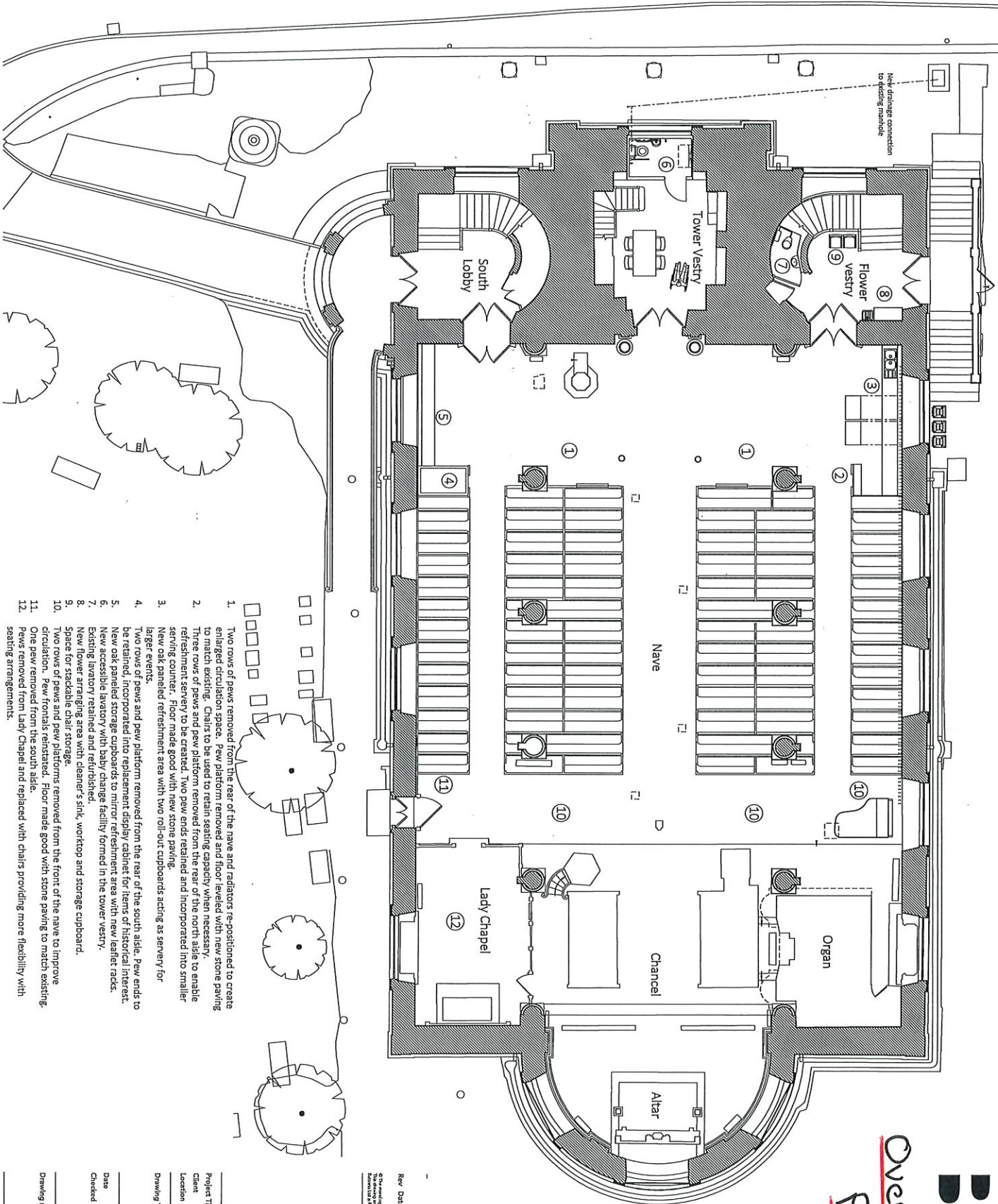

1. Two rows of pews removed from the rear of the nave and radiators re-positioned to create enlarged circulation space. Pew platform removed and floor levelled with new stone paving to match existing. Chairs to be used to retain seating capacity when necessary.
2. Three rows of pews and pew platform removed from the rear of the north aisle to enable refreshment server to be created. Two pew ends retained and incorporated into smaller serving counter. Floor made good with new stone paving.
3. New oak paneled refreshment area with two roll-out cupboards acting as servery for larger events.
4. Two rows of pews and pew platform removed from the rear of the south aisle. Pew ends to be retained, incorporated into replacement display cabinet for items of historical interest. New oak paneled storage cupboards to mirror refreshment area with new leaflet racks.
5. New accessible lavatory with baby change facility formed in the tower vestry.
6. Existing lavatory retained and refurbished.
7. New flower arranging area with cleaner's sink, worktop and storage cupboard.
8. Space for stackable chair storage.
9. Two rows of pews and pew platforms removed from the front of the nave to improve circulation. Pew frontals reinstated. Floor made good with stone paving to match existing.
10. One pew removed from the south aisle.
11. Pews removed from Lady Chapel and replaced with chairs providing more flexibility with seating arrangements.
- 12.

## Riv Details Details

© The overall design of the building was developed by Buttress in 2017 and is the intellectual property of Buttress. All rights reserved. Buttress is a registered company in England and Wales (202272).

# Buttress

41 Bengal St  
Manchester  
M4 6AF  
T: 0161 236 3933  
E: [enquiries@buttress.net](mailto:enquiries@buttress.net)  
W: [www.buttress.net](http://www.buttress.net)

**Project Title** St Almund's Church  
**Client** The PCC of St Almund  
**Location** Whichurch, Stroudshire

**Drawing Title** Proposed rendering  
Plan as proposed

Date	Nov. 2021	Scale	1:100
Checked	SW	Orig Paper Size	A2
		Status	

Drawing ref	Job No	Drawing No	Revision
8839.		(04) 01	-